



Yuasa Scheda Tecnica

Yuasa YB16L-B - YuMicron Batteria

Prestazione

Tensione	12V
Capacità (10 ore)	19Ah
Capacità (20 ore)	20Ah
CCA @ -18°C	215A

Dimensioni (±2mm)

Lunghezza	175mm
Profondità	100mm
Altezza	155mm

Pesi e Misure

Peso medio con acido	6.3kg
Volume dell'acido	1.2l



Tecnologia

Tecnologia	Piastra Sb/Sb
Separatore	Synthetic Resin+Glass Fiber

Schema di Collegamento

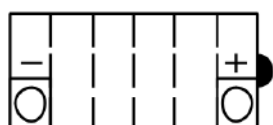

Tipologia dei terminali - 6

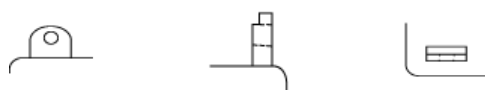

Scheda tecnica prodotta su E&OE



Yuasa Technical Data Sheet

Yuasa YB16L-B - YuMicron Battery

Performance

Voltage	12V
Capacity (10-hour)	19Ah
Capacity (20-hour)	20Ah
CCA @ -18°C	215A

Dimensions (±2mm)

Length	175mm
Width	100mm
Height	155mm

Weights & Measures

Mean Weight with Acid	6.3kg
Acid Volume	1.2l



Technology

Technology	Cast Sb/Sb
Separator	Synthetic Resin+Glass Fiber

Cell Assembly Layout

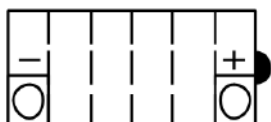

Terminal Type - 6

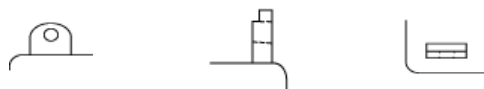

Data Sheet generated on 08/09/2021 – E&OE