



Yuasa Scheda Tecnica

Yuasa B38-6A - Convenzionali 6V Batteria

Prestazione

| | |
|-------------------|--------|
| Tensione | 6V |
| Capacità (10 ore) | 13Ah |
| Capacità (20 ore) | 13.7Ah |

Dimensioni (±2mm)

| | |
|------------|-------|
| Lunghezza | 119mm |
| Profondità | 83mm |
| Altezza | 161mm |

Pesi e Misure

| | |
|----------------------|-------|
| Peso medio con acido | 2.9kg |
| Volume dell'acido | 0.62l |

Tecnologia

| | |
|------------|-------------------------------|
| Tecnologia | Piastra Sb/Sb |
| Separatore | Reinforcing fiber+Glass Fiber |



Schema di Collegamento



Tipologia dei terminali - 6

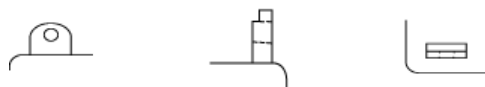

Scheda tecnica prodotta su E&OE



Yuasa Technical Data Sheet

Yuasa B38-6A - Conventional 6 Volt Battery

Performance

| | |
|--------------------|--------|
| Voltage | 6V |
| Capacity (10-hour) | 13Ah |
| Capacity (20-hour) | 13.7Ah |

Dimensions (±2mm)

| | |
|--------|-------|
| Length | 119mm |
| Width | 83mm |
| Height | 161mm |

Weights & Measures

| | |
|-----------------------|-------|
| Mean Weight with Acid | 2.9kg |
| Acid Volume | 0.62l |

Technology

| | |
|------------|-------------------------------|
| Technology | Cast Sb/Sb |
| Separator | Reinforcing fiber+Glass Fiber |



Cell Assembly Layout



Terminal Type - 6

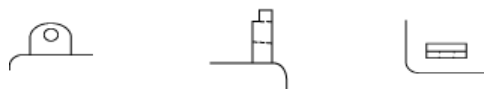

Data Sheet generated on 08/09/2021 - E&OE