



Yuasa Scheda Tecnica

Yuasa 6N12A-2D - Convenzionali 6V Batteria

Prestazione

Tensione	6V
Capacità (10 ore)	12Ah
Capacità (20 ore)	12.6Ah

Dimensioni (±2mm)

Lunghezza	156mm
Profondità	57mm
Altezza	116mm

Pesi e Misure

Peso medio con acido	2.3kg
Volume dell'acido	0.45l

Tecnologia

Tecnologia	Piastra Sb/Sb
Separatore	Reinforcing fiber+Glass Fiber



Schema di Collegamento

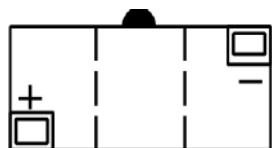

Tipologia dei terminali - 6

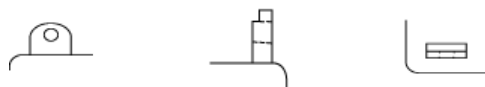

Scheda tecnica prodotta su E&OE



Yuasa Technical Data Sheet

Yuasa 6N12A-2D - Conventional 6 Volt Battery

Performance

Voltage	6V
Capacity (10-hour)	12Ah
Capacity (20-hour)	12.6Ah

Dimensions ($\pm 2\text{mm}$)

Length	156mm
Width	57mm
Height	116mm

Weights & Measures

Mean Weight with Acid	2.3kg
Acid Volume	0.45l

Technology

Technology	Cast Sb/Sb
Separator	Reinforcing fiber+Glass Fiber



Cell Assembly Layout

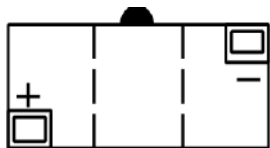

Terminal Type - 6

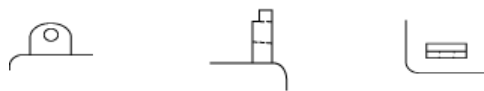

Data Sheet generated on 08/09/2021 - E&OE