



Yuasa Scheda Tecnica

Yuasa 6N11-2D - Convenzionali 6V Batteria

Prestazione

Tensione	6V
Capacità (10 ore)	11Ah
Capacità (20 ore)	11.6Ah

Dimensioni (±2mm)

Lunghezza	150mm
Profondità	70mm
Altezza	100mm

Pesi e Misure

Peso medio con acido	2kg
Volume dell'acido	0.4l

Tecnologia

Tecnologia	Piastra Sb/Sb
Separatore	Synthetic Resin+Glass Fiber



Schema di Collegamento

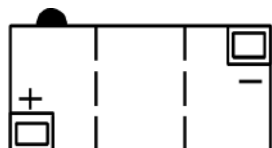

Tipologia dei terminali - 6

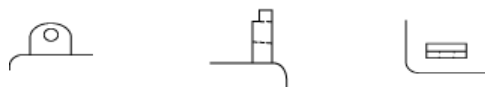

Scheda tecnica prodotta su E&OE



Yuasa Technical Data Sheet

Yuasa 6N11-2D - Conventional 6 Volt Battery

Performance

Voltage	6V
Capacity (10-hour)	11Ah
Capacity (20-hour)	11.6Ah

Dimensions ($\pm 2\text{mm}$)

Length	150mm
Width	70mm
Height	100mm

Weights & Measures

Mean Weight with Acid	2kg
Acid Volume	0.4l



Technology

Technology	Cast Sb/Sb
Separator	Synthetic Resin+Glass Fiber

Cell Assembly Layout



Terminal Type - 6

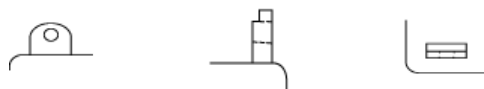

Data Sheet generated on 08/09/2021 - E&OE