



## Yuasa Scheda Tecnica

### Yuasa 12N11-3B - Convenzionali 12V Batteria

#### Prestazione

Tensione	12V
Capacità (10 ore)	11Ah
Capacità (20 ore)	11.6Ah
CCA @ -18°C	109A

#### Dimensioni (±2mm)

Lunghezza	135mm
Profondità	90mm
Altezza	155mm

#### Pesi e Misure

Peso medio con acido	3.6kg
Volume dell'acido	0.8l

#### Tecnologia

Tecnologia	Piastra Sb/Sb
Separatore	Reinforcing fiber+Glass Fiber



#### Schema di Collegamento



#### Tipologia dei terminali - 6

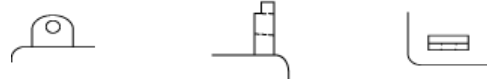

Scheda tecnica prodotta su E&OE



## Yuasa Technical Data Sheet

### Yuasa 12N11-3B - Conventional 12 Volt Battery

#### Performance

Voltage	12V
Capacity (10-hour)	11Ah
Capacity (20-hour)	11.6Ah
CCA @ -18°C	109A

#### Dimensions (±2mm)

Length	135mm
Width	90mm
Height	155mm

#### Weights & Measures

Mean Weight with Acid	3.6kg
Acid Volume	0.8l

#### Technology

Technology	Cast Sb/Sb
Separator	Reinforcing fiber+Glass Fiber



#### Cell Assembly Layout

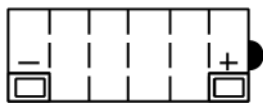

#### Terminal Type - 6

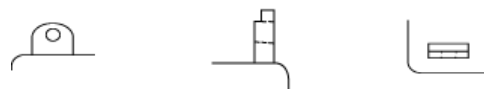

Data Sheet generated on 08/09/2021 - E&OE