

Central Article Code: C74023F01-A
 Local Code: ETZ14-BS

Created: 30/09/2010
 Modified: 15/12/2020

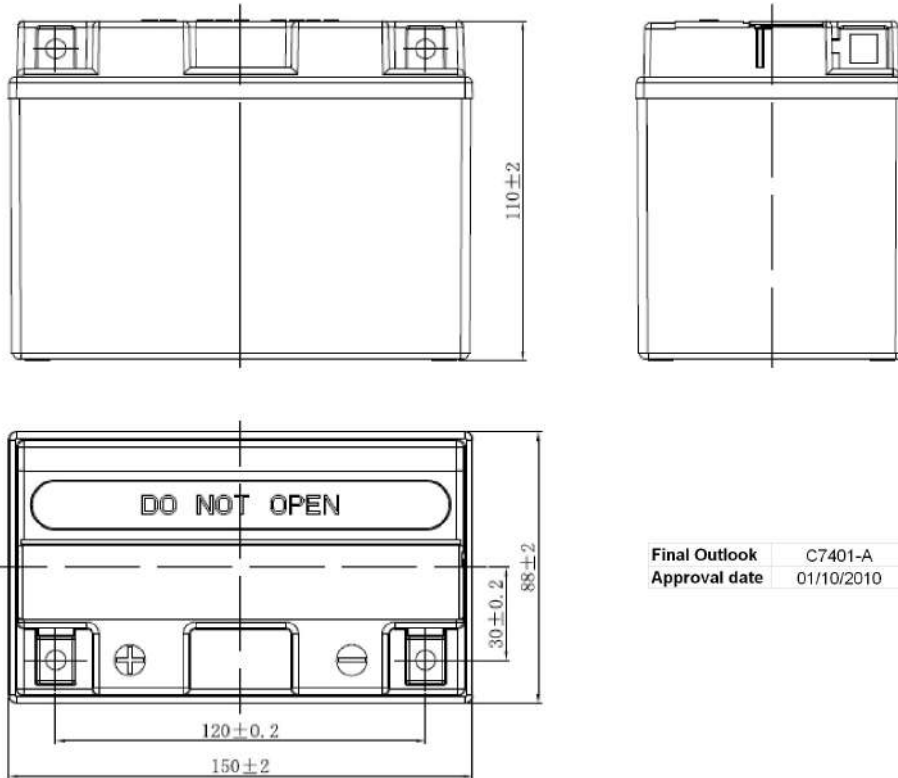

Final Outlook	C7401-A
Approval date	01/10/2010

PERFORMANCES		CONTAINER	
Voltage (V):	12 V	Type:	C74 BLACK
C20 (Ah):	11.0 10 h	Hold Down:	B0
Cranking (A):	205 EN	H.D. Adapter:	No
Charge:	DRY	COVER	
Technology:	AGM	Type:	Motorbike (independ BLACK
Grid:	Ca/Ca	Polarity:	ETN 1
Vibration:	Not Defined	Terminals:	M04
Endurance:	Not Defined	Terminal Adapter:	No
		SOCI:	No
		Ventilation:	Sealed
		Filter:	No
		Lateral Plug:	No
STD. DIMENSIONS		PLUGS	
Length (mm ± 2):	150	Type:	1 x Vent BLACK
Width (mm ± 2):	90	HANDLES	
Height (mm ± 2):	110	Type:	None
Total Weight (kg ± 5%):	4.10	OTHERS	
<p>This is a dry battery supplied with bottles of sulphuric acid. Sale of acid to end users is forbidden by Eu.Reg.1148/2019. Dry batteries must be filled with acid before delivery to end users</p> <p>All figures show nominal values. Tolerances are according to EN50342 and applicable European Regulations.</p>		Degassing Tube:	No