

Central Article Code: C53019F02-A

Created: 27/10/2006

Local Code: ETZ10-BS

Modified: 15/12/2020

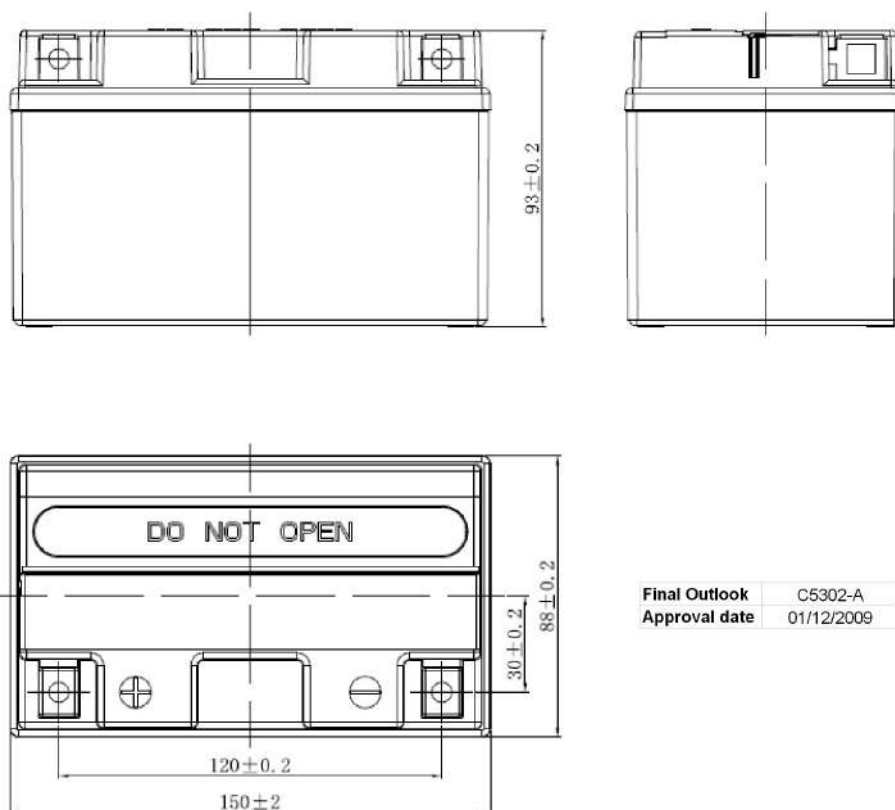

Final Outlook	C5302-A
Approval date	01/12/2009

PERFORMANCES

Voltage (V):	12 V	
C20 (Ah):	9.0	10 h
Cranking (A):	145	EN
Charge:	DRY	
Technology:	AGM	
Grid:	Ca/Ca	
Vibration:	Not Defined	
Endurance:	Not Defined	

STD. DIMENSIONS

Length (mm ± 2):	150
Width (mm ± 2):	90
Height (mm ± 2):	95
Total Weight (kg ± 5%):	3.40

This is a dry battery supplied with bottles of sulphuric acid. Sale of acid to end users is forbidden by Eu.Reg.1148/2019. Dry batteries must be filled with acid before delivery to end users

All figures show nominal values. Tolerances are according to EN50342 and applicable European Regulations.

CONTAINER

Type:	C53	BLACK
Hold Down:	B0	
H.D. Adapter:	No	

COVER

Type:	Motorbike (independ	BLACK
Polarity:	ETN 1	
Terminals:	M12	
Terminal Adapter:	No	
SOCI:	No	
Ventilation:	Sealed	
Filter:	No	
Lateral Plug:	No	

PLUGS

Type:	1 x Vent	BLACK
-------	----------	-------

HANDLES

Type:	None
-------	------

OTHERS

Degassing Tube:	No
-----------------	----

YTZ10S