

Central Article Code: C68030D01-A
 Local Code: E60-N30L-B

Created: 05/09/2005
 Modified: 15/12/2020

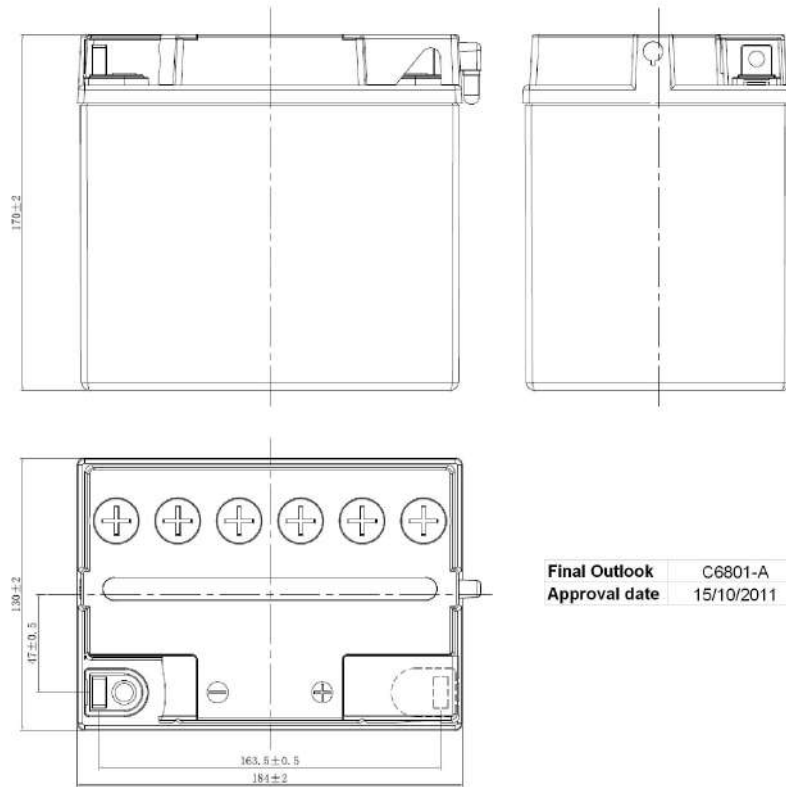

PERFORMANCES

Voltage (V):	12 V	
C20 (Ah):	30.0	10 h
Cranking (A):	300	EN
Charge:	DRY	
Technology:	Vented/Flooded	
Grid:	Low Sb	
Vibration:	Not Defined	
Endurance:	Not Defined	

STD. DIMENSIONS

Length (mm ± 2):	185
Width (mm ± 2):	130
Height (mm ± 2):	170
Total Weight (kg ± 5%):	8.90

This is a dry battery supplied with bottles of sulphuric acid. Sale of acid to end users is forbidden by Eu.Reg.1148/2019. Dry batteries must be filled with acid before delivery to end users

All figures show nominal values. Tolerances are according to EN50342 and applicable European Regulations.

CONTAINER

Type:	C68	WHITE
Hold Down:	B0	
H.D. Adapter:	No	

COVER

Type:	Motorbike (B ventilati BLACK
Polarity:	ETN 0
Terminals:	M11
Terminal Adapter:	No
SOCI:	No
Ventilation:	Moto-B
Filter:	No
Lateral Plug:	No

PLUGS

Type:	6 x Moto Plug	RED
-------	---------------	-----

HANDLES

Type:	None
-------	------

OTHERS

Degassing Tube:	No
-----------------	----